

Planta Baja E1/300

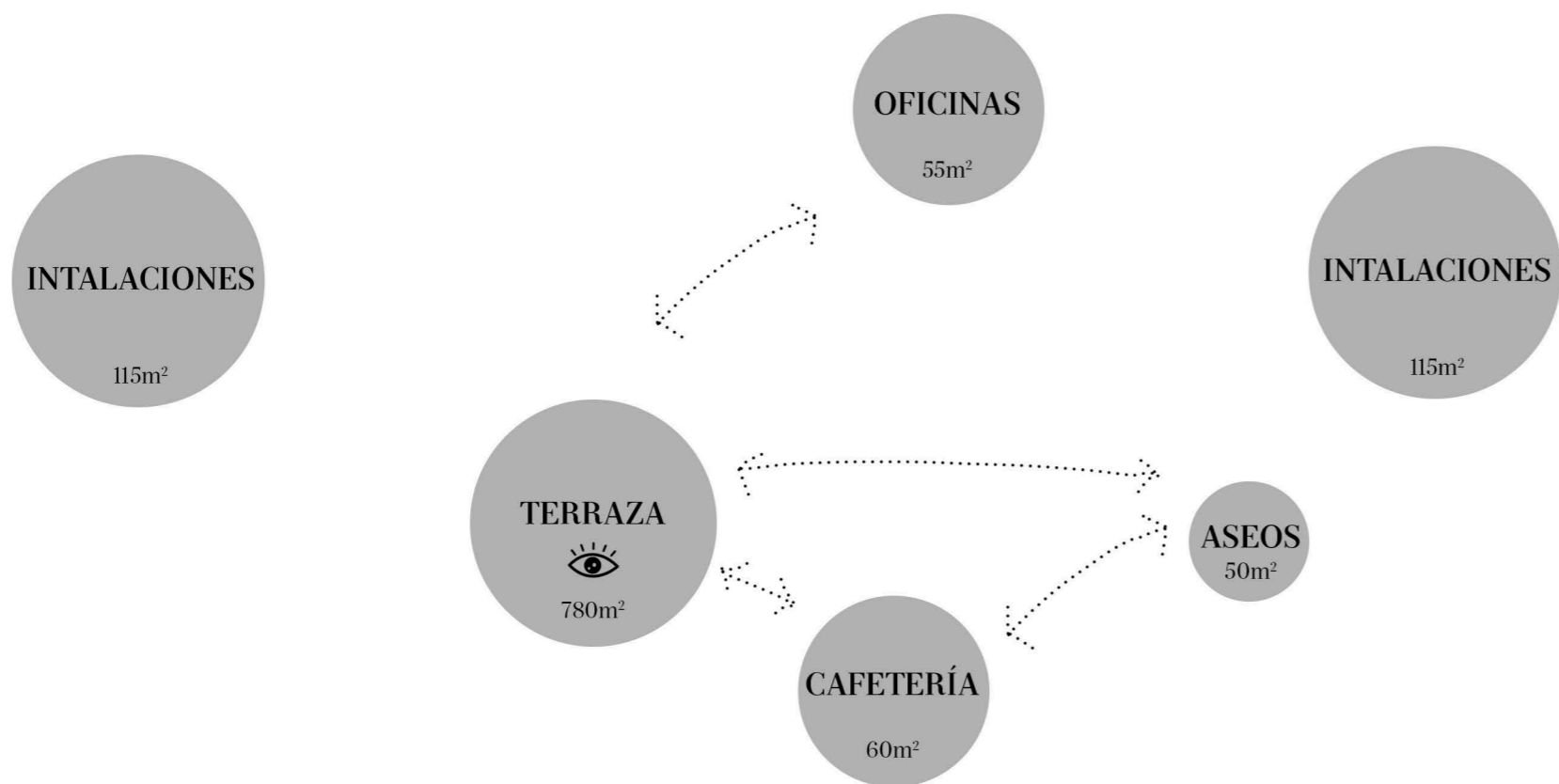

Planta Primera E1/300

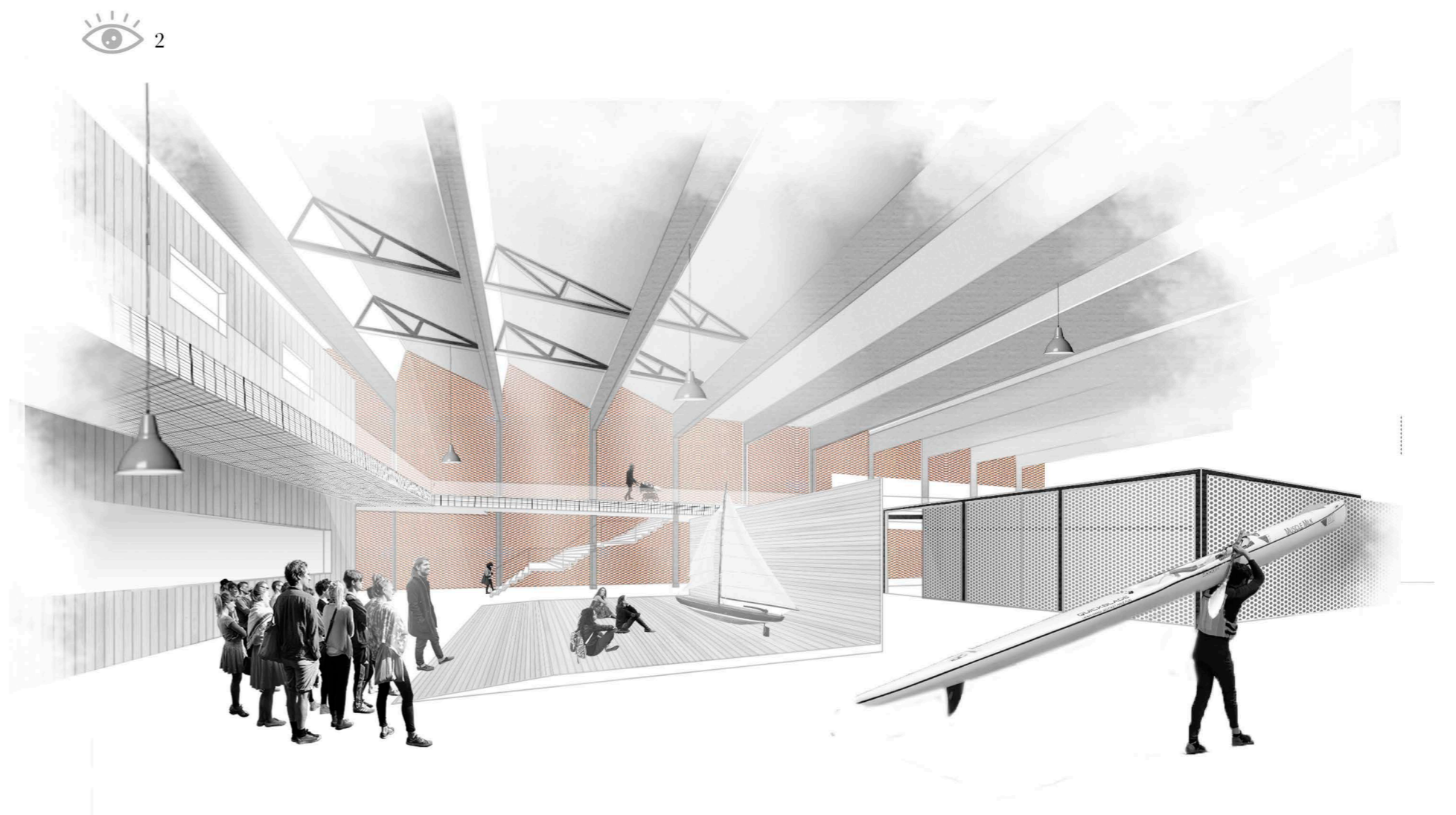
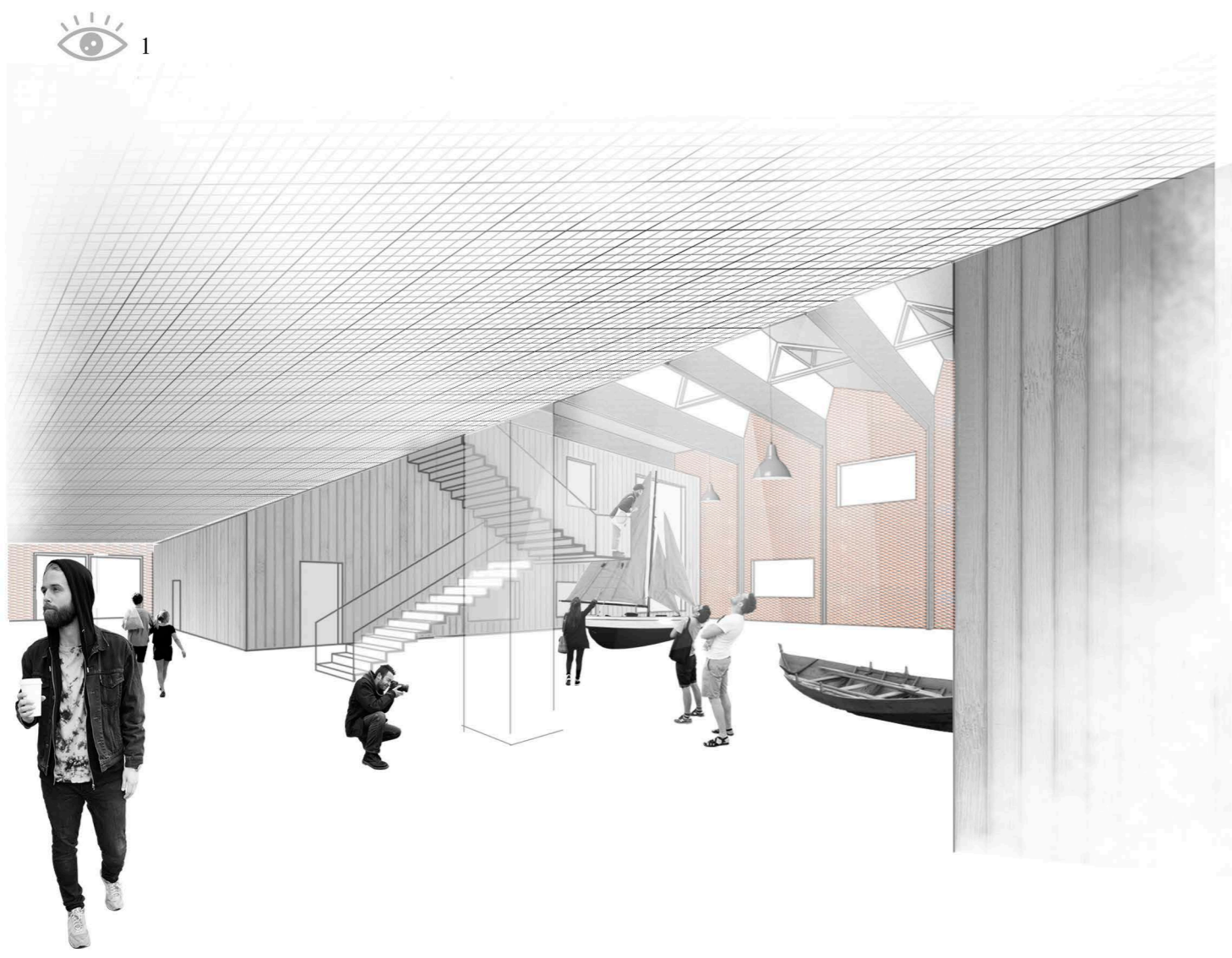
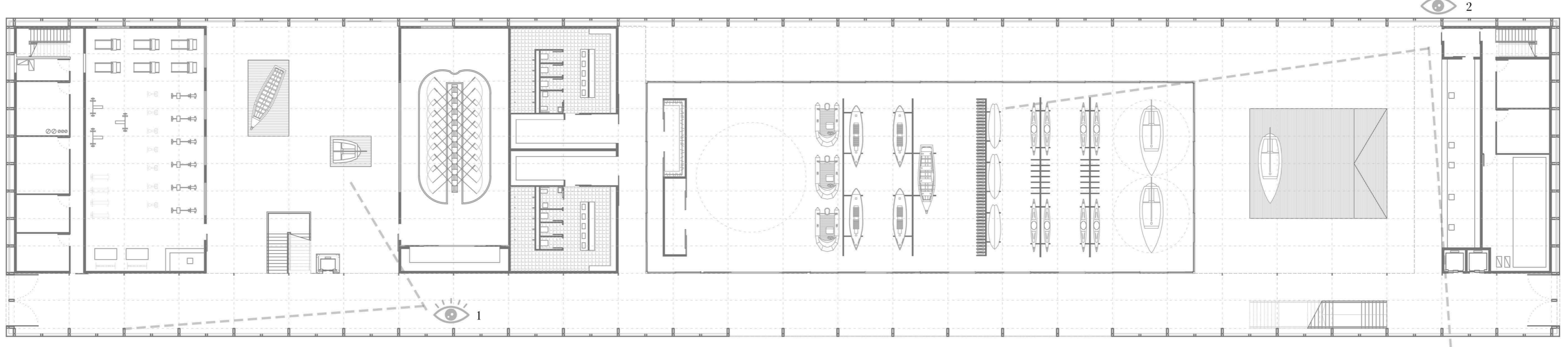
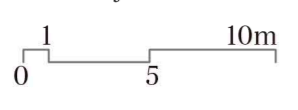
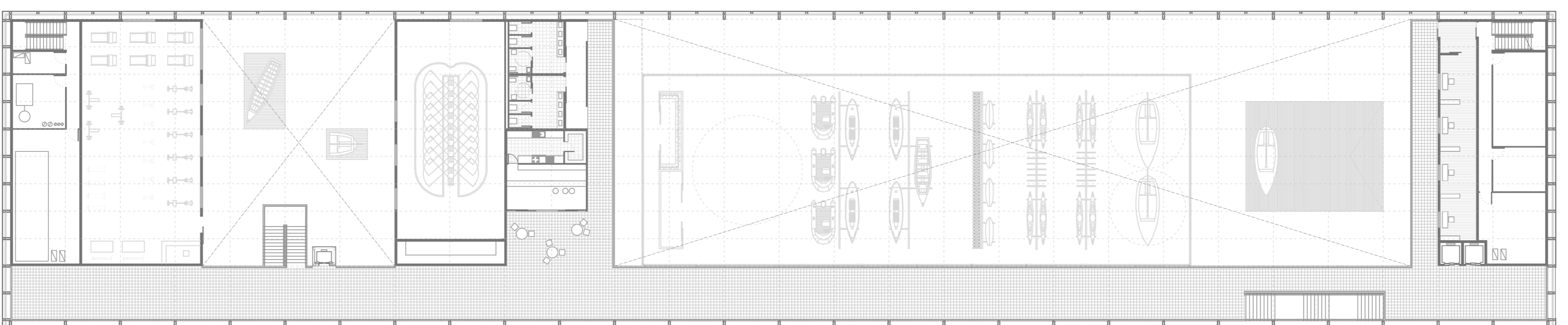
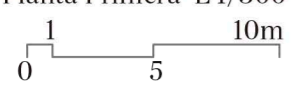

CENTRO DE DEPORTES ACUÁTICOS EN LA DÁRSENA DE SESTAO

Alumna Natalia Lázaro Herranz Tutor Luis Ramón Sesé Madrazo
Escuela Técnica Superior de Arquitectura de San Sebastián a 18 de septiembre de 2015



© 2015, Natalia Lázaro Herranz